

**ISOMETRIC VIEW
(FRONT)**

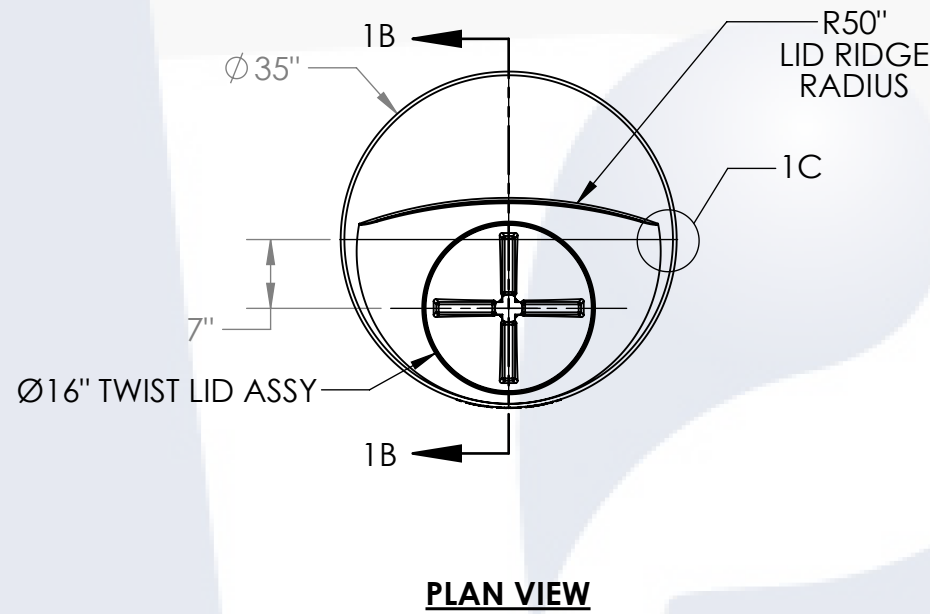

DETAIL 1C
SCALE 1:8

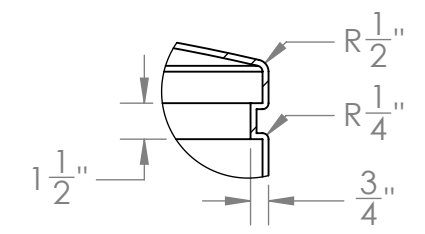

DETAIL 1A
SCALE 1:8

1°
LID ANGLE

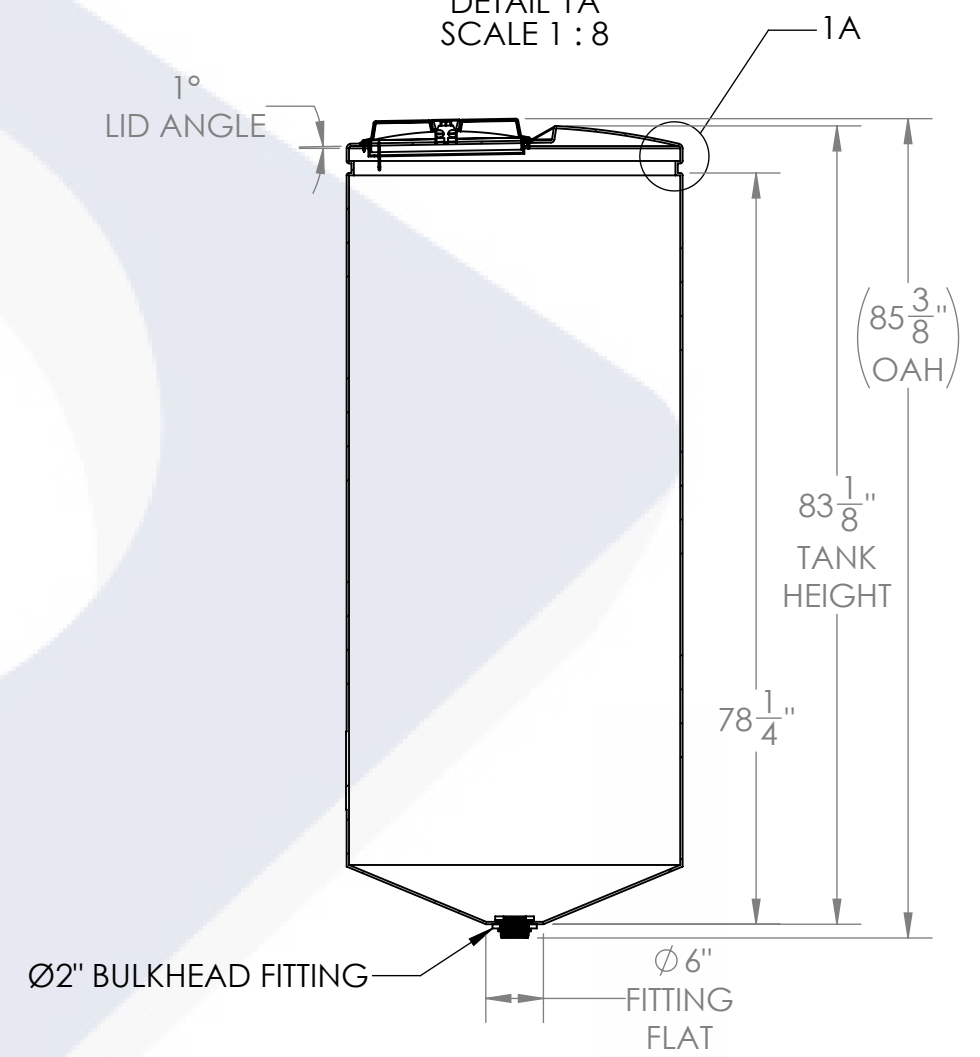

- NOTES:**
- CAPACITY: 300 GAL. NOMINAL
 - TANK MATERIAL: XLPE
 - SERVICE PRESSURE: ATMOSPHERIC
 - NSF/ANSI STANDARD 61 CERTIFIED

PROPRIETARY AND CONFIDENTIAL
THE INFORMATION CONTAINED IN THIS DRAWING IS THE SOLE PROPERTY OF PEABODY ENGINEERING. ANY REPRODUCTION IN PART OR AS A WHOLE WITHOUT THE WRITTEN PERMISSION OF PEABODY ENGINEERING IS PROHIBITED.

UNLESS OTHERWISE SPECIFIED:
DIMENSIONS ARE IN INCHES
TOLERANCES: ±1/4"
ANGULAR: ±.5°
ONE PLACE DECIMAL: ±.25
TWO PLACE DECIMAL: ±.125
THREE PLACE DECIMAL: ±.063

TANK MATERIAL:
INNER TANK S/N:
OUTER TANK S/N:
CUSTOMER PO#

DO NOT SCALE DRAWING

	NAME	DATE
DRAWN	SMF	03/01/23
CHECKED		
ENG APPR.		
MFG APPR.		
Q.A.		

PROJECT: PROCHEM® TANKS		REV. B
SITE/LOCATION: -		SCALE: 1:20
SALES ORDER: -		
SIZE B	DESC. 300GAL CONE BOTTOM TANK	SHEET 1 OF 1

